

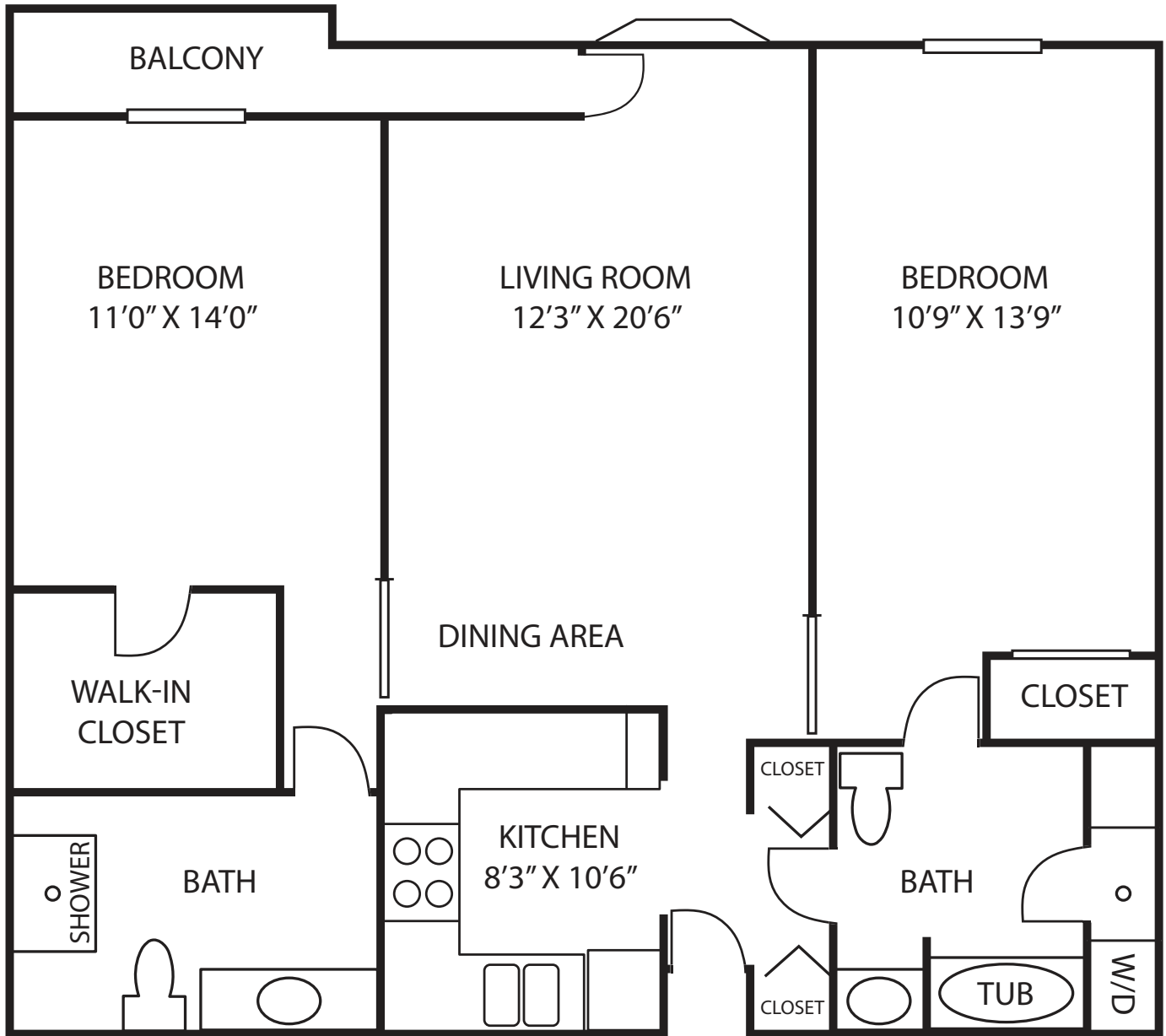

# INDEPENDENT LIVING

Terrace Floor Plan

*Webster*



## Webster

- Park Terrace
- Two Bedrooms
- 1,150 square feet

2018 2BC



**LUTHER MANOR**  
A Life Plan Community

Wauwatosa, Grafton and Mequon  
414.464.3880 | live@luthermanor.org | luthermanor.org



### Webster - Park Terrace Two Bedrooms

	Founder's Fee	Monthly Fee One Person*	Monthly Fee Two People*
90% Refundable Founder's Fee	\$189,000	\$3,034	\$3,467
Non-Refundable Founder's Fee	\$69,000	\$3,034	\$3,467

*The Founder's Fee includes priority access to the full continuum of care at Luther Manor.*

### Amenities

Included with monthly fees are:

- \$230 dining credit per resident
- All utilities including basic cable (excludes phone)
- Wide range of Life Enrichment activities
- Outdoor parking

Indoor parking is available for an additional fee.

\*For apartments with a fountain view, add 10%. For apartments with golf course view, gazebo view, or proximity to dining, add 5%.

### Notes:

---



---



---



---



---



---

